

● W-S/3200

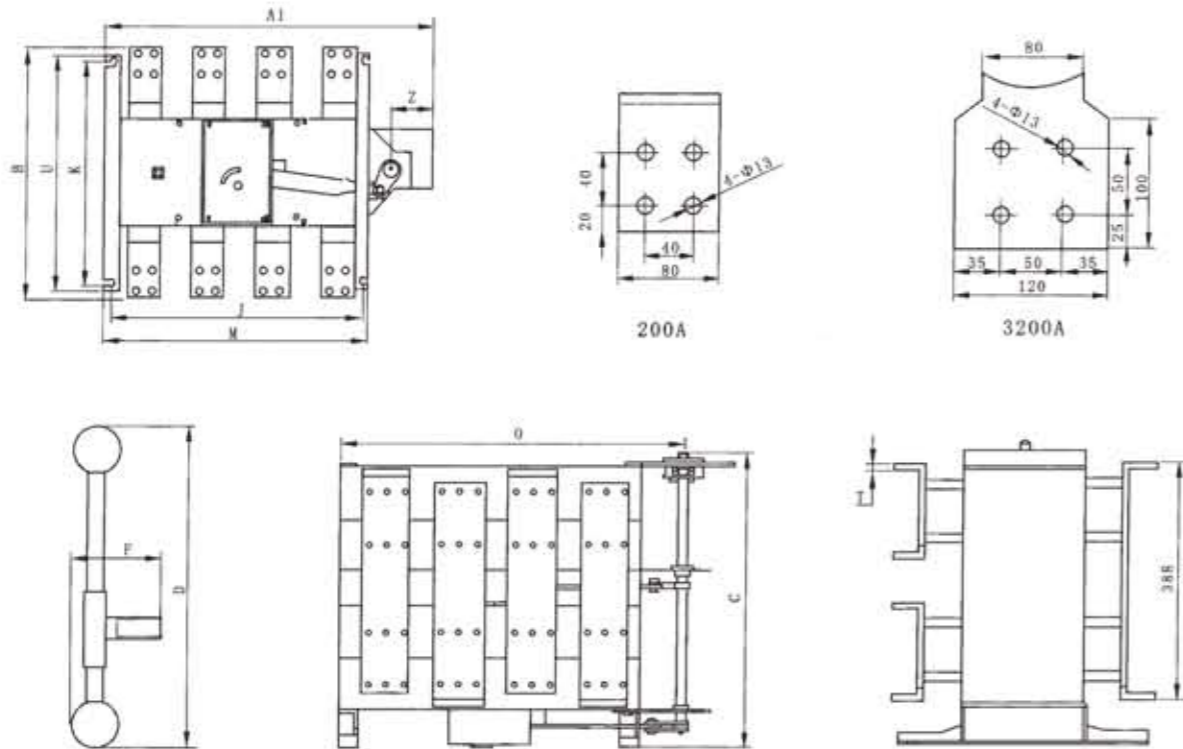

Specification	Outer dimensions						Installation dimensions					Wiring dimensions			Operating handle			
	A1	B	C	E	M	U	J	K	L	Z	N	R	T	ΦX	D	F	G	
100	3																	
	4	236	135	165	143	170	130	155	110	7	32.5	22	20	2.5	9	167	54.5	145
250	3													3.5				
	4	296	159.5	190	166	228	130	213	110	7	32.5	22	25	6	11	167	54.5	145
630	3	301	260	257	236	230	210	210	178	9	32.5	22	40	6	13	167	54.5	145
	4	368	260	254	232	290	270	270	178	9	32.5	22	40	15	13	167	54.5	145
1600	3	484	360	328	300	378	360	360	220	11	63	28	80	15	4-13	330	72	
	4	596	360	328	300	492	470	470	220	11	63	28	80	15	4-13	330	72	
3200	3	484	510	495		378	360	360	355	11	63	20	120	15	4-13	550	85	550
	4	596	510	495		492	470	470	355	11	63	20	120	15	4-13	550	85	550

III. Controller selection sheet

Controller	Function	Application scope
WST-3	<ul style="list-style-type: none"> ◇ Delay ◇ Overvoltage protection ◇ Undervoltage protection ◇ Open phase protection ◇ Overcurrent protection ◇ Line voltage display ◇ Current display ◇ Power indication ◇ Remote clearing ◇ Generator startup (automatic) ◇ 485 communications interface (optional) 	Universal
WST-1	<ul style="list-style-type: none"> ◇ Delay ◇ Overvoltage protection ◇ Undervoltage protection ◇ Open phase protection ◇ Overcurrent protection ◇ Line voltage display ◇ Current display ◇ Power indication ◇ Remote clearing ◇ Generator startup (automatic) ◇ 485 communications interface (optional) ◇ Timing ◇ Automatic input and recovery; automatic input and nonautomatic recovery 	Universal
WN-2-3-JJ (Concise)	<ul style="list-style-type: none"> ◇ Delay ◇ Open phase protection ◇ Power indication ◇ Remote clearing ◇ Generator startup (automatic) 	Below 630A

